

SK16 Collets

SK16 Collets

Size range: 2.75mm - 16.0mm (0.108 - 0.630")

Metric

Part Number	Collapse Range (mm)	Collapse Range (in)	Figure
SK16-3	2.75 - 3.0	0.108 - 0.118"	1
SK16-3.5	3.0 - 3.5	0.118 - 0.137"	1
SK16-4	3.5 - 4.0	0.137 - 0.157"	1
SK16-4.5	4.0 - 4.5	0.157 - 0.177"	1
SK16-5	4.5 - 5.0	0.177 - 0.196"	1
SK16-5.5	5.0 - 5.5	0.196 - 0.216"	1
SK16-6	5.5 - 6.0	0.216 - 0.236"	1
SK16-6.5	6.0 - 6.5	0.236 - 0.255"	1
SK16-7	6.5 - 7.0	0.255 - 0.275"	1
SK16-7.5	7.0 - 7.5	0.275 - 0.295"	1
SK16-8	7.5 - 8.0	0.295 - 0.314"	1
SK16-8.5	8.0 - 8.5	0.314 - 0.334"	1
SK16-9	8.5 - 9.0	0.334 - 0.354"	1
SK16-9.5	9.0 - 9.5	0.354 - 0.374"	1
SK16-10	9.5 - 10.0	0.374 - 0.394"	1
SK16-10.5	10.0 - 10.5	0.394 - 0.413"	2
SK16-11	10.5 - 11.0	0.413 - 0.433"	2
SK16-11.5	11.0 - 11.5	0.433 - 0.452"	2
SK16-12	11.5 - 12.0	0.452 - 0.472"	2
SK16-12.5	12.0 - 12.5	0.472 - 0.492"	2
SK16-13	12.5 - 13.0	0.492 - 0.511"	2
SK16-13.5	13.0 - 13.5	0.511 - 0.531"	2
SK16-14	13.5 - 14.0	0.531 - 0.551"	2
SK16-14.5	14.0 - 14.5	0.551 - 0.570"	2
SK16-15	14.5 - 15.0	0.570 - 0.590"	2
SK16-15.5	15.0 - 15.5	0.590 - 0.610"	2
SK16-16	15.5 - 16.0	0.610 - 0.630"	2
SK16-SET-27-MM	27 Piece SK16 Collet Set - 2.75mm - 16.0mm		

Inch

Part Number	Size	Figure
SK16-1/8A	0.125"	1
SK16-3/16A	0.187"	1
SK16-1/4A	0.250"	1
SK16-5/16A	0.312"	1
SK16-3/8A	0.375"	1
SK16-7/16A	0.437"	1
SK16-1/2A	0.500"	1
SK16-9/16A	0.562"	1
SK16-5/8A	0.625"	1
SK16-SET-09-A	9 Piece SK16 Collet Set - 1/8 - 5/8" X16th	

These inch size collets do not collapse.

Dimensional Data

Collet Series	C1	L1	Collapse Range (D1)
SK16	0.945" (24mm)	1.772" (45mm)	0.108 - 0.630" (2.75 - 16.0mm)

Metric - Coolant-Thru

Up to 1000 psi capable.

Part Number	Size	Figure
SK16-6AC	6mm	2
SK16-7AC	7mm	2
SK16-8AC	8mm	2
SK16-9AC	9mm	2
SK16-10AC	10mm	2
SK16-11AC	11mm	2
SK16-12AC	12mm	2
SK16-14AC	14mm	2
SK16-16AC	16mm	2

Note:
Cutter must be inserted to the full length of the collet.

Inch - Coolant-Thru

Up to 1000 psi capable.

Part Number	Size	Figure
SK16-7/16AC	0.437"	2
SK16-1/2AC	0.500"	2
SK16-9/16AC	0.562"	2
SK16-5/8AC	0.625"	2

Note: AC-type collets are mechanically sealing and can handle coolant through the tool up to 1000 psi. No additional coolant disk or nut is required when using these collets.

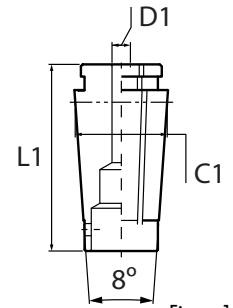

Figure 1

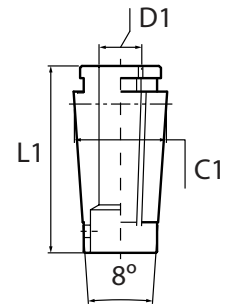

Figure 2

SK16 Collet Rack



Part Number	Description
RACK-180DA/SK16/ER25	SK16 collet rack, 30 collets capacity

Note: SK Collet Drill Chart available on page 248 in the Technical section.

